

Russell Hobbs®

INSTRUCTIONS AND WARRANTY



MODEL NO. 18277-56

2-IN-1 GRAVITY GRINDER

Congratulations on purchasing our Russell Hobbs 2-in-1 Gravity Grinder. Each unit is manufactured to ensure safety and reliability. Before using this appliance for the first time, please read the instruction manual carefully and keep it for future reference.

IMPORTANT SAFEGUARDS

When using any electrical appliance, basic safety precautions should always be followed including the following:

1. Please read the instructions carefully before using any appliance.
2. Always ensure that the voltage on the rating label corresponds to the mains voltage in your home.
3. Incorrect operation and improper use can damage the appliance and cause injury to the user.
4. The appliance is intended for household use only. Commercial use invalids the warranty and the supplier can not be held responsible for injury or damage caused when using the appliance for any other purpose than that intended.
5. Avoid any contact with moving parts.
6. This appliance is not intended for use by persons (including children) with reduced physical, sensory or mental capabilities, or lack of experience and knowledge, unless they have been given supervision or instruction concerning use of the appliance by a person responsible for their safety.
7. Children should be supervised to ensure that they do not play with the appliance.
8. Do not use the appliance if it has been dropped or damaged in any way. In case of damage, take the unit in for examination and/or repair by an authorised service agent.
9. To reduce the risk of electric shock, do not immerse or expose the motor assembly to water or any other liquid.
10. Never immerse the full unit in water or any other liquid for cleaning purposes.
11. The use of accessory attachments that are not recommended or supplied by the manufacturer may result in injuries, fire or electric shock.
12. Do not use the appliance on a gas or electric cooking top or over or near an open flame.
13. This appliance is not suitable for outdoor use. Do not use this appliance for anything other than its intended use.
14. Do not place the unit on a hot surface.

15. The manufacturer does not accept responsibility for any damage or injury caused by improper or incorrect use, or for repairs carried out by unauthorised personnel.
16. In case of technical problems, switch off the appliance and do not attempt to repair it yourself. Return the appliance to an authorised service facility for examination, adjustment or repair. Always insist on the use of original spare parts. Failure to comply with the above mentioned pre-cautions and instructions, could affect the safe operation of this machine.

PARTS DIAGRAM

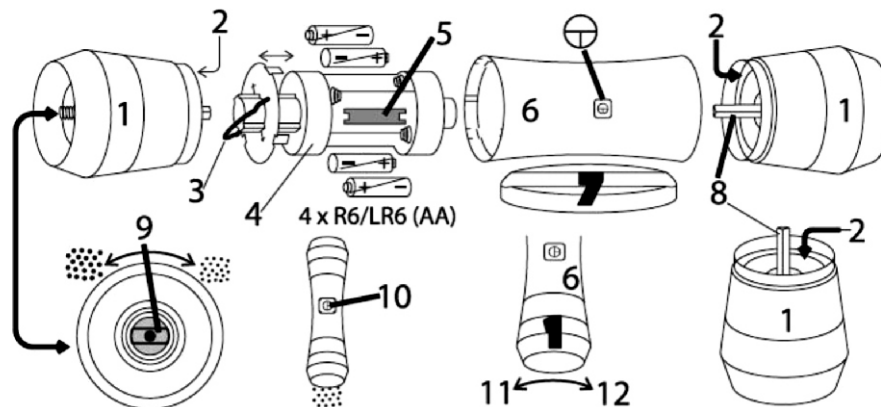

drawing	5 contact plate	⊗ coarse
1 grinder	6 handle	⊗ fine
2 peppercorns	⊕ switch	10 press
3 grip	7 stand	11 unlock
4 motor unit	8 spindle	12 lock
⊕ ⊖ batteries	9 knob	

OPERATING INSTRUCTIONS

FITTING BATTERIES~

1. Hold the appliance horizontally, with the ⊕ symbol the right way up.
2. You need to remove the left grinder.
3. Turn the appliance 90° anti-clockwise.
4. Turn the bottom grinder 6mm clockwise to unlock it.

5. Lower the grinder from the handle.
6. Turn the appliance through 180°.
7. Pull the grip, to remove the motor unit from the handle.
8. Fit 4 x R6/LR6 (AA) batteries into the motor unit.
9. Don't use different kinds of batteries together (they should all be carbon-zinc, or all alkaline).
10. The polarities (+ -) are marked on the battery compartment.
11. Align the contact strip on the motor unit with the switch.
12. Replace the motor unit in the handle.
13. The end with the grip should sit about 6mm inside the handle.
14. Push the grinder back into the handle.
15. Push the grinder 6mm anti-clockwise to lock it into place.

FILLING THE GRINDER~

1. Hold the appliance vertically.
2. Turn the bottom grinder 6mm clockwise to unlock it.
3. Lower the grinder by the handle.
4. Fill the grinder with peppercorns, sea salt, dried herbs or spices.
5. Push the grinder back into handle.
6. Turn the grinder 6mm anti-clockwise to lock it into place.
7. Follow the same procedure for the remaining grinder.

ADJUSTING THE GRIND INTENSITY~

1. Turn the knob on top of the grinder right until it won't go any further.
2. Now, turn it slightly to the left.
3. Press and release the switch.
4. Check the grind size and adjust it until it is the way you want it.
5. Don't turn it more than 6 complete turns towards , or you may unscrew the knob from the spindle.

GRINDING~

1. Hold the appliance with the grinder you want to use at the bottom.
2. The motor unit should slide down, inside the handle, to engage with the bottom grinder.
3. If it sticks, give the appliance a gentle shake.
4. Press the switch to start the motor, release it to switch off.

CLEANING AND MAINTENANCE

- This appliance is for household use only and is not user-serviceable.
- Do not open or change any parts by yourself. Please refer to a qualified electrical service department or return to the supplier if servicing is necessary.
- The body of the appliance and the stand should be cleaned with a damp cloth. Do not let water enter the appliance or the stand.

- Do not use bleach or other abrasive substance or solvents to clean your appliance as it can be damaging to the finish.
- Do not immerse the appliance in water or any other liquid, or hold it under a running tap to clean.
- To remove stubborn spots/marks, wipe the surfaces with a cloth slightly dampened in soapy water or mild non-abrasive cleaner. Rinse and dry with a clean, dry, soft cloth.

STORING THE APPLIANCE

- Ensure that all parts are dry before storing.
- Store the appliance in its box or in a clean, dry place.
- Never store the appliance while it is still wet or dirty.

SERVICING THE APPLIANCE

There are no user serviceable parts in this appliance. If the unit is not operating correctly, please check the following:

- You have followed the instructions correctly
- Batteries are working and inserted correctly

If the appliance still does not work after checking the above:

- Consult the retailer for possible repair or replacement. If the retailer fails to resolve the problem and you need to return the appliance, make sure that:

- The unit is packed carefully back into its original packaging.
- Proof of purchase is attached.
- A reason is provided for why it is being returned.

If the motor unit is damaged, it must be replaced by the manufacturer or an authorised service agent, in order to avoid any hazard. If service becomes necessary within the warranty period, the appliance should be returned to an approved Tedalex Trading (Pty) Limited service centre. Servicing outside the warranty period is still available, but will, however, be chargeable.

**PLEASE AFFIX YOUR PROOF OF PURCHASE/RECEIPT HERE
IN THE EVENT OF A CLAIM UNDER WARRANTY THIS RECEIPT MUST BE PRODUCED.**

WARRANTY

1. Tedalex Trading (Pty) Limited ("Tedalex") warrants to the original purchaser of this product ("the customer") that this product will be free of defects in quality and workmanship which under normal personal, family or household use and purpose may manifest within a period of 1 (one) year from the date of purchase ("warranty period").
2. Where the customer has purchased a product and it breaks, is defective or does not work properly for the intended purpose, the customer must notify the supplier from whom the customer bought the product ("the supplier") thereof within the warranty period. Any claim in terms of this warranty must be supported by a proof of purchase. If proof of purchase is not available, then repair, and/or service charges may be payable by the customer to the supplier.
3. The faulty product must be taken to the supplier's service centre to exercise the warranty.
4. The supplier will refund, repair or exchange the product in terms of this warranty subject to legislative requirements. This warranty shall be valid only where the customer has not broken the product himself, or used the product for something that it is not supposed to be used for. The warranty does not include and will not be construed to cover products damaged as a result of disaster, misuse, tamper, abuse or any unauthorised modification or repair of the product.
5. This warranty will extend only to the product provided at the date of the purchase and not to any expendables attached or installed by the customer.
6. If the customer requests that the supplier repairs the product and the product breaks or fails to work properly within 3 (three) months of the repair and not as a result of misuse, tampering or modification by or on behalf of the customer, then the supplier may replace the product or pay a refund to the customer.
7. The customer may be responsible for certain costs where products returned are not in the original packaging, or if the packaging is damaged. This will be deducted from any refund paid to the customer.

TEDELEX TRADING (PTY) LTD (JOHANNESBURG)

JOHANNESBURG

TEL NO. (011) 490-9600

CAPE TOWN

TEL NO. (021) 535-0600

DURBAN

TEL NO. (031) 792-6000

www.amap.co.za