

Russell Hobbs®

INSTRUCTIONS AND WARRANTY



**MODEL NO. RH11C
RUSSELL HOBBS ELECTRIC 11 FIN OIL RADIATOR**

Congratulations on purchasing our Russell Hobbs Electric 11 Fin Oil Radiator. Each unit is manufactured to ensure safety and reliability. Before using this radiator for the first time, please read the instruction manual carefully and keep it for future reference.

PART NAME & LOCATION

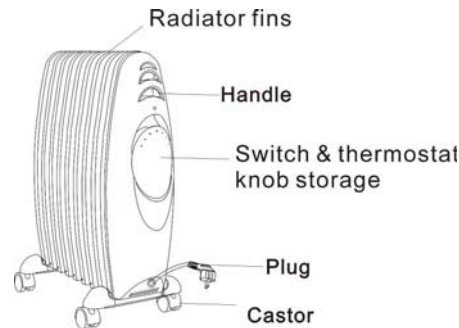

FEATURES OF THE RUSSELL HOBBS ELECTRIC 11FIN OIL RADIATOR

- The Russell Hobbs 11 Fin Oil Radiator has a stylish European design.
- The variable thermostat knob allows you to control the output of the radiator, according to the ambient temperature and size of the room being heated.
- The radiator is fitted with sturdy wheels for easy mobility.
- The unique design of the radiator covers larger heating surface allowing more efficient heating than most other oil radiation.
- The automatic temperature control keeps the temperature of the room at the desired level.
- The power on indicator light will show when the radiator is in use.

IMPORTANT SAFEGUARDS

When using any electrical radiator, basic safety precautions should always be followed including the following:

1. Please read the instructions carefully before using any radiator.
2. Always ensure that the voltage on the rating label corresponds to the mains voltage in your home.
3. Incorrect operation and improper use can damage the radiator and cause injury to the user.

4. The radiator is intended for household use only. Commercial use invalidates the warranty and the supplier can not be held responsible for injury or damage caused when using the radiator for any other purpose than that intended.
5. Close supervision is required when any radiator is used near or by children or invalids.
6. Check the power cord and plug regularly for any damage. If the cord or the plug is damaged, it must be replaced by the manufacturer or a qualified person in order to avoid an electrical hazard.
7. Do not use the radiator if it has been dropped or damaged in any way. In case of damage, take the unit in for examination and/or repair by an authorised service agent
8. To reduce the risk of electric shock, do not immerse or expose the motor assembly, plug or the power cord to water or any other liquid.
9. Never immerse the unit in water or any other liquid for cleaning purposes.
10. Remove the plug from the socket by firmly pulling the plug. Do not pull on the cord to disconnect the radiator from the mains. Always unplug the unit when not in use.
11. The use of accessory attachments that are not recommended or supplied by the manufacturer may result in injuries, fire or electric shock.
12. A short cord is provided to reduce the hazards resulting from becoming entangled in or tripping over a longer cord.
13. Ensure that the cord is not in a position where it can be pulled on inadvertently.
14. Do not allow the cord to touch hot surfaces.
15. Use of an extension cord with this radiator is not recommended. However, if it is necessary to use an extension lead, ensure that the lead is suited to the power consumption of the radiator to avoid overheating of the extension cord, radiator or plug point. Do not place the extension cord in a position where it can be pulled on by children or animals or tripped over.
16. This radiator is not suitable for outdoor use. Do not use this radiator for anything other than its intended use.
17. DO NOT carry the radiator by the power cord.
18. Do not leave this radiator unattended during use. Always unplug the unit when not in use or before cleaning.
19. Ensure that the switch is in the "Off" position after each use.

20. The manufacturer does not accept responsibility for any damage or injury caused by improper or incorrect use, or for repairs carried out by unauthorised personnel.
21. In case of technical problems, switch off the radiator and do not attempt to repair it yourself. Return the radiator to an authorised service facility for examination, adjustment or repair. Always insist on the use of original spare parts. Failure to comply with the above mentioned pre-cautions and instructions, could affect the safe operation of this radiator.

ASSEMBLY INSTRUCTIONS:

The radiator is packaged with the castor wheels unattached. You must attach them before operating the radiator.

WARNING: Do not operate without castor wheels attached. Operate the radiator only in an upright position.

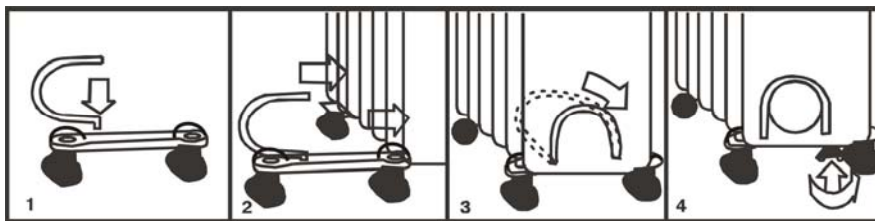

- Place the radiator body upside-down on a scratch-free location, make sure it is stable and will not fall.
- To attach the castor mounting plate to the radiator body, you should insert the threaded ends of the U bolt in the holes on the castor mounting plate.
- Screw the wing nuts back to the U bolt and fasten the wing nut properly.
- Your radiator castor wheels are now assembled.
- Turn it the right way up to operate.
- The radiator is ready for use.

OPERATING INSTRUCTIONS

1. The radiator must be placed on a flat level surface.
2. Turn the thermostat control clockwise to the desired setting.
3. Switch the radiator to one of the following power settings:

- a) Push switch one (1) for Low heat. To keep a pleasant temperature in a room.
 - b) Push switch two (2) for Medium. This setting is ideal if sitting in a room for long periods of time.
 - c) Push switches one (1) & two (2) together, for rapid High heat. This setting is ideal to warm up a room quickly.
4. The power switch lights up when activated.
 5. Do not cover the radiator at any time during operation. There is a risk of fire if the radiator is covered.
 6. Once you have finished using your radiator, turn the power switches off and the thermostat control switch to the "0" positions, and unplug from the mains supply.

CLEANING AND MAINTENANCE

- This radiator is for household use only and is not user-serviceable.
- Do not open or change any parts by yourself. Please refer to a qualified electrical service department or return to the supplier if servicing is necessary.
- Always remember to unplug the unit from the electrical outlet when not in use and before cleaning. Ensure that the heat control is set to off and has cooled down.
- The body of the radiator should be cleaned with a damp cloth. Do not let water enter the radiator.
- Do not use bleach or other abrasive substance or solvents to clean your radiator as it can be damaging to the finish.
- Do not immerse the radiator in water or any other liquid, or hold it under a running tap to clean.
- To remove stubborn spots/marks, wipe the surfaces with a cloth slightly dampened in soapy water or mild non-abrasive cleaner.

STORING THE RADIATOR

- Unplug the unit from the wall outlet and clean all the parts as instructed above. Ensure that all parts are dry before storing.
- Store the radiator in its box or in a clean, dry place.
- Never store the radiator while it is still wet or dirty.
- Never wrap the power cord around the radiator.

SERVICING THE RADIATOR

There are no user serviceable parts in this radiator. If the unit is not operating correctly, please check the following:

- You have followed the instructions correctly
- That the unit has been wired correctly and that the wall socket is switched on.
- That the mains power supply is ON.
- That the plug is firmly in the mains socket.

If the supply cord is damaged, it must be replaced by the manufacturer or an authorised service agent, in order to avoid any hazard. If service becomes necessary within the warranty period, the radiator should be returned to an approved Amalgamated Appliances (Pty) Ltd service centre. Servicing outside the warranty period is still available, but will, however, be chargeable.

CHANGING THE PLUG

Should the need arise to change the fitted plug, follow the instructions below.

This unit is designed to operate on 230V current only. Connecting to other power sources may damage the radiator. Connect a three-pin plug as follows:

The wires in this mains lead are coloured in accordance with the following code:

Green/Yellow = Earth
Blue = Neutral
Brown = Live

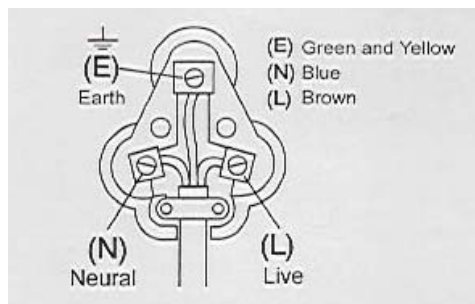

**PLEASE AFFIX YOUR PROOF OF PURCHASE/RECEIPT HERE
IN THE EVENT OF A CLAIM UNDER WARRANTY THIS RECEIPT MUST BE
PRODUCED.**

WARRANTY

Amalgamated Appliances (Pty) Limited ("the Supplier") warrants to the original purchaser of this product ("the Customer") that this product will be free of defects in material and workmanship which under normal, personal, family or household purpose manifest themselves within a period of 365 days from the date of purchase or in respect of commercial or professional purposes, manifest themselves within a period of 90 days from the date of purchase. Any claim in terms of the warranty must be supported by a proof of purchase. If such proof is not available, then notwithstanding anything to the contrary herein, the Supplier's normal charge for service and/or spares will be payable by the Customer upon collection of the repaired product. If a claim is made in terms of the aforesaid warranty within the first 7 days from the date of purchase, the faulty product will be exchanged (provided that the product is in its original packaging with all accessories). Failing return of the product within 7 days, the Supplier's liability shall be limited on return to the Supplier of the product or parts thereof, to the replacement or repair (in the sole discretion of the Supplier, or its duly authorised service dealer) of the product to eliminate any defect in workmanship or materials found to be due exclusively to any acts or omissions on the parts of the Suppliers, of which defects the Supplier shall have been notified in writing by the Customer within the aforesaid warranty period. The warranty provided herein and the obligations of the Supplier as aforesaid are in lieu of, and the Customer waives, all other warranties, guarantees, conditions or liabilities, express or implied, arising by law or otherwise, including without limitation, any obligation of the Supplier in respect of any injury, loss or damage (direct, indirect or consequential) arising out of the use of, or inability to use, this product and whether or not occasioned by the Supplier's negligence (gross or otherwise) or any act or omission on its part. The warranty does not include and will not be construed to cover products damaged as a result of disaster, misuse, abuse or any non-authorized modification of the product. The warranty does not include replacement of light bulbs, radiator bars, paper bags or any glass, plastic bowl or jug or other expendables. During the warranty period the product should be taken to a service centre of the Supplier or one of its duly authorised service agents. The Supplier neither assumes nor authorises any other person to assume for it, any additional liability in connection with the sale or servicing of its products.

AMALGAMATED APPLIANCES (PTY) LTD

JOHANNESBURG
29 HERONMERE ROAD
P O BOX 39186
BOOYSENS, JOHANNESBURG, 2016

TEL NO. (011) 490-9000

CAPE TOWN

TEL NO. (021) 535-0600

DURBAN

TEL NO. (031) 792-6000

REGISTER YOUR PURCHASE ONLINE – www.russellhobbs.co.za